

---

---

## ENTRY METHOD

**ENTRIES OPEN ON Friday, December 6<sup>th</sup> at 8 AM CST** at the Trial Secretary's address via US mail or hand delivered. No entries to be emailed or faxed or taken over the phone. Entries received prior to the opening date shall be treated as an invalid entry and shall be returned to the sender. Overnight or certified mail must be sent with the "No Signature Required" waiver signed.

**ENTRIES WILL CLOSE ON Monday, December 23<sup>rd</sup> at 5 PM CST** after which time entries cannot be accepted, cancelled, altered, or substituted.

**DAY OF EVENT ENTRIES:** Day of event entries will be permitted at this Fetch testing provided that the maximum test entries have not been met.

---

---

## PREMIUM LIST



**Go Dogs Agility Club of Greater Omaha,  
an AKC Member Club**

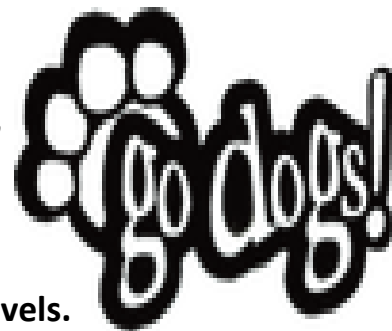

**Test will include Novice, Intermediate and Advanced levels.**

**December 28, 2024** Trial 1, Event #2024527411, Trial 2, Event #2024527412  
**2 judges, so a title can be earned if you qualify in both tests.**  
**Trials will run concurrently.**

**Location:** Gretna Sports Complex  
10550 S 222<sup>nd</sup> St  
Gretna, NE 68028

## ENTRY LIMITS

**A maximum of 30 entries, including both novice and intermediate levels combined, and 6 advanced entries, will be accepted inclusive of both tests.**

*To be held indoors on turf.*

## Testing Hours

Saturday- the event will begin at the completion of the AKC Agility trial, around 5 PM.  
Check-in to begin at 4:30 PM.

***You must be checked in by 5:00 PM for all events to ensure you can complete your test(s).***



**AMERICAN  
KENNEL CLUB**

## CERTIFICATION

Permission is granted by the American Kennel Club for the holding of this event under American Kennel Club rules and regulations.

Gina DiNardo, Secretary

### Trial Chair(s)

<p>Chelsea Kardell 1614 Grandview Ave # 19 Papillion, NE 68045 <a href="mailto:chelseakardell@gmail.com">chelseakardell@gmail.com</a></p>	<p>Sharee Newman 2111 S 67<sup>th</sup> St. Ste 450 Omaha, NE 68106 <a href="mailto:snotch2@gmail.com">snotch2@gmail.com</a></p>
---	--

### Test Secretary

Mindy Begley  
2205 S 43<sup>rd</sup> St  
Omaha, NE 68105  
[Mindyk1@aol.com](mailto:Mindyk1@aol.com)

### Event Committee

Mary Ruhe, Rose Strasser, Sharee Newman, Darla Hook, Emily Johnson

### Judges and Assignments

#### Jen Howell

Judge # 113741  
Omaha, NE

December 28, 2024  
Trial 1

Novice, Intermediate and Advanced

#### Jessica Bock

Judge # 92614  
Omaha, NE

December 28, 2024  
Trial 2

Novice, Intermediate and Advanced

### EMERGENCY VETERINARY SERVICE

**Urgent Pet Care - Papillion**  
8455 S 73rd Plaza Papillion, NE 68046  
402-509-2606

**Urgent Pet Care – Millard**  
4257 S 144<sup>th</sup> St, Omaha, NE 68137  
402-275-4711

### EMERGENCY SERVICES

**Fire/Ambulance/Police – Douglas County – Dial 911**  
**Closest Local Hospital – CHI Health Midlands** 11111 S 84<sup>th</sup> St, Papillion, NE 68046  
Located 13 miles from the FETCH testing site

## TEST LEVELS OFFERED

**Saturday, December 28, 2024**

**Novice – two tests offered**

**Intermediate – two tests offered**

**Advanced – two tests offered**

- Testing begins at approximately 5 PM and will continue until the completion of the entries.
- Move-ups WILL be offered. Move up forms must be completed and turned into the check-in table prior to the next test starting.

## DOGS ELIGIBLE TO ENTER

This trial is open to all dogs SIX (6) months of age or older that are registered with the American Kennel Club or that have AKC Limited Registration, Purebred Alternative Listing/Indefinite Listing Privileges (PAL/ILP), an AKC Canine Partners listing number or approved Foundation Stock Service (FSS) breeds are eligible to participate.

**Condition of the Dog.** Dogs with physical challenges (including amputees) are eligible to participate provided that, in the opinion of the judge, they display no signs of physical discomfort and can safely complete the Fetch test. Dogs with bandages, sutures, or visible wounds are not eligible. Deaf dogs are allowed to enter so long as the handler is in control of the dog at all times, the dog can complete the requirements of the test, and the dog does not appear to be under undue stress in the opinion of the judge.

## ENTRY FEES

**\$25.00 per test (Please note two tests are being offered)**

**\$30.00 per test for entries received after the closing date, provided that the test entry limits have not been met.**

Make checks out to: **GoDogs**

Mail Entries to:

Mindy Begley  
2205 So. 43<sup>rd</sup> Street  
Omaha, NE 68105

No entries will be accepted by phone, email, or fax. Express mail entries must include the signature waiver allowing them to be left at the secretary's address.

Inquiries may be directed to Mindy Begley at [mindyk1@aol.com](mailto:mindyk1@aol.com).

No entry shall be made, and no entry shall be accepted which specifies any conditions as to its acceptance.

**Illegible entries** will not be processed and will be returned to the exhibitor. Returned checks do not constitute a valid entry and the. Trial Secretary will add a \$25.00 collection fee to the amount of each returned check.

## REFUNDS

- Requests for refunds **prior to the closing date** will be granted. All requests must be made directly to the test secretary, Mindy Begley at [mindyK1@aol.com](mailto:mindyK1@aol.com)
- If a request for refund is made **after the closing date** will be granted **IF** the spot can be filled by someone on the waitlist.
- No requests for refunds will be granted if there is no one to take the spot off the wait list.

## WAITLIST

A waitlist will be kept by the test secretary if the entry limit is met, up to 20 entries. If an entry is submitted and does not make it off the waitlist, the entry and payment will be shredded.

## CRATING

There will be designated crating space inside of the Gretna Sports Complex.  
Exhibitors can also crate from their car if they desire.  
Please be sure that dogs are well secured, to avoid loose dogs in the Complex.  
No flexi leashes or long lines will be allowed on the grounds of the test.  
Dogs must be on leash any time they are not crated or being tested.  
While the test is inside, plan to keep yourself and your dog comfortable in the December Nebraska weather.

## ADDITIONAL SITE INFORMATION

**Exhibitors are responsible** for cleaning up after their dog(s). Any exhibitor failing to do so may be excused without benefit of refund if the Event Committee deems the exhibitor to be in violation of this requirement. Poop bags and disposal sites will be available at various locations around the show grounds. Dogs are not allowed to potty in the areas where the Fetch tests are taking place.

## RIBBONS AND AWARDS

*Qualifying Score.....Dark Green Flat Ribbon*  
*New Title.....Navy, turquoise and silver Rosette*

## NOTICE TO EXHIBITORS

### SAFETY, BEHAVIOR and LIABILITY

**The safety of the dog** is our primary concern. By entering this trial, exhibitors acknowledge that they are familiar with the rules and regulations of this sport, and that their dogs are familiar with and able to perform all searches safely. **It is expressly understood** that exhibitors alone are responsible for the behavior of their dogs and/or children. Any exhibitor whose dogs and/or children create an unnecessary disturbance or repeatedly engage in unsafe or disruptive behavior may, at the discretion of the trial committee, be asked to leave the show site. In such case, no refund of any fees paid will be made. The American Kennel Club and its agents, employees, etc., will assume no responsibilities for any loss, damage or injury sustained by exhibitors or handlers, or to any of their dogs or property and further assumes no responsibility for injury to children. The American Kennel Club reserves the right to decline entries for cause and may remove any dog on account of aggression. No one shall have any recourse or claim against the American Kennel Club or any official thereof.

**Collars, Leashes, and Harnesses.** Dogs must wear a collar. Dogs may wear slip collars, buckle collars, and Martingales in the AKC Fetch test. They may not wear prong collars, e-collars, head collars, muzzles, or body harnesses. Leashes should be 4 ft. to 6 ft. long and should be made of fabric, leather, or biothane.

### REFUNDS

**No entry fee** will be refunded if the trial cannot open or be completed by reason of riots, civil disturbances, fire, an act of God, public emergency, act of a public enemy, or any other cause beyond the control of the organizing committee. No entry fee will be refunded in the event a dog is absent, disqualified, excused, or barred from competition by the action of the Trial Committee

**Bitches in season** will be refunded the full entry fee. Notification in writing must be given to the trial secretary no later than one half hour prior to the start of the first class of the day of the trial.

### RINGSIDE

**Judges are not required** to wait for dogs. The Owner of each dog is solely responsible for having it ready at the search area when it is to be judged. The Club and the Judges have no responsibility to provide service through a public address system or stewards or runners for the purpose of calling or locating dogs that are not brought into the ring when required.

**EXHIBITOR CHECK-IN:** In the welcome letter, you will be advised as to your check in time. After check in, you will be given your run order. All exhibitors must check-in with the secretary upon arrival.

**Claims will be arbitrated as set forth on the Official AKC Entry Form for this event.**

Exhibitors should follow their veterinarian's recommendation to assure their dogs are free of internal and external parasites, any communicable diseases, and have appropriate vaccinations.

## HOTEL AND CAMPGROUND INFORMATION

### Hotel:

Holiday Inn Express & Suites  
16175 Stevens Point Circle  
Gretna, NE 68028  
402-504-3716

Check with hotel regarding current rates and pet policy when making reservations. Some restrictions may apply.

### Campground:

Camping is unavailable due to sites being closed for winter.

## DIRECTIONS TO SITE

*From I-80 Omaha: Head West on I-80; take exit 439 for NE 370 Gretna. Turn Right on 370 to Gretna. Turn right on US-6 East. Turn Left onto Lincoln Road. Turn right onto S 222<sup>nd</sup> St, and the building will be on the right.*

## MAP

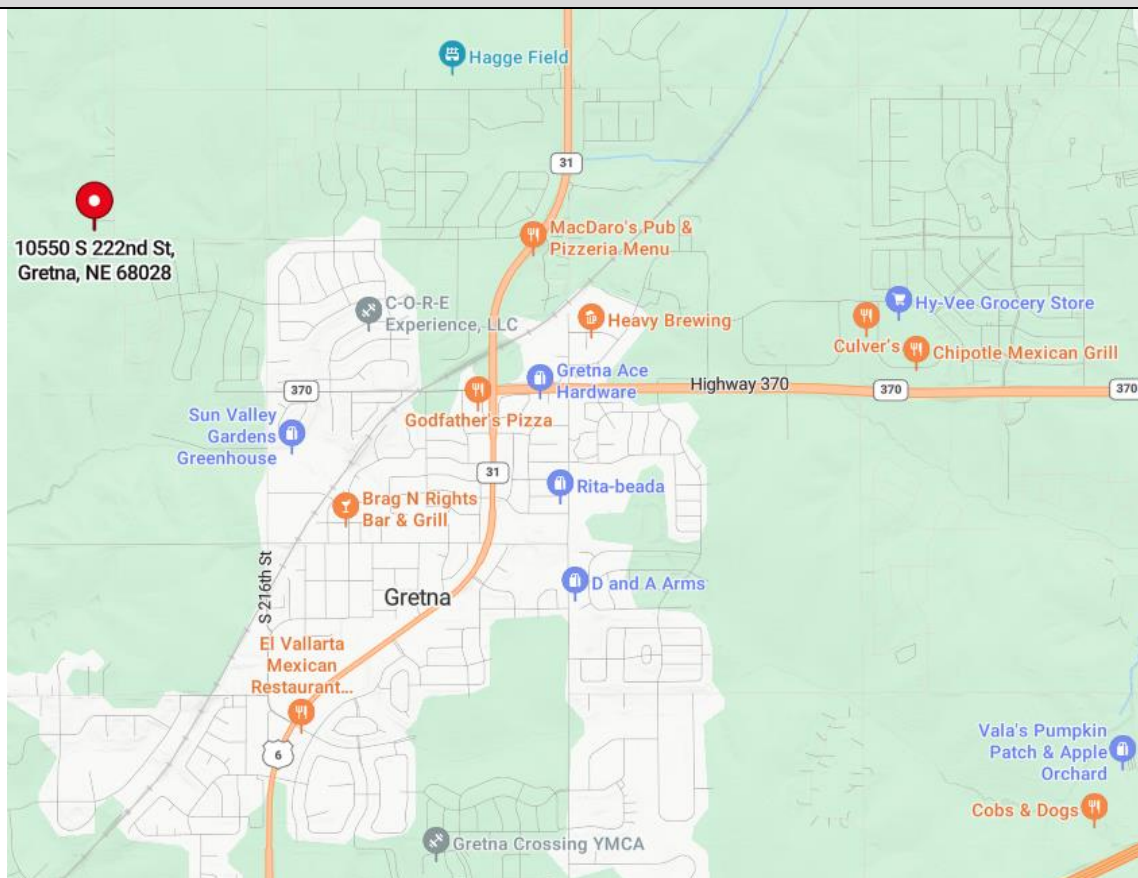

## AKC OFFICIAL ENTRY FORM

Please check the box of the test(s) that you are entering. Note: No dog can be entered in more than one class per test. A new entry form must be used for each dog.

<b>Test 1</b> Sat, Dec 28, 2024	<b>Novice</b> <input type="checkbox"/>	<b>Intermediate</b> <input type="checkbox"/>	<b>Advanced</b> <input type="checkbox"/>
---------------------------------	--	--	--

<b>Test 2</b> Sat, Dec 28, 2024	<b>Novice</b> <input type="checkbox"/>	<b>Intermediate</b> <input type="checkbox"/>	<b>Advanced</b> <input type="checkbox"/>
---------------------------------	--	--	--

**Entry fees: \$25.00 per test  
(\$30.00 per test for entries received after closing date)**

Make checks out to: GoDogs

Mail entry to:  
Mindy Begley  
2205 So. 43<sup>rd</sup> Street  
Omaha, NE 68105

# of tests entered \_\_\_\_\_ \$ \_\_\_\_\_ total amount of entry fees

AKC Registered Name		Registration Number	
		<input type="checkbox"/> AKC/PAL/ILP/CP <input type="checkbox"/> Foreign	
Call name	Date of birth	Sex	
Breed			
Owner			
Owner's Address			
City		State	Zip
Telephone	Email		
Handler name (if different from owner):		Junior Handler # (if applicable):	

**Fields marked in blue are REQUIRED.**

**Fields marked in gray must be completed if the information is known.**

**\*\*\*Be sure to read the Agreement and sign on the following page.**

**No form will be processed without your signature!**

Guidelines are available on the American Kennel Club Web site at:

[www.akc.org/fetch](http://www.akc.org/fetch)

AGREEMENT

I certify that I am the actual owner of the dog, or that I am the duly authorized agent of the actual owner whose name I have entered. In consideration of the acceptance of this entry, I (we) agree to abide by the rules and regulations of The American Kennel Club in effect at the time of this event, and any additional rules and regulations appearing in the premium list of this event and entry form and any decision made in accord with them. I (we) agree that the club holding this event has the right to refuse this entry for cause which the club shall deem sufficient. I (we) certify and represent that the dog entered is not a hazard to persons or other dogs. In consideration of the acceptance of this entry and of the holding of this event and of the opportunity to have the dog judged and to win prizes, ribbons, or trophies, I (we) agree to hold the AKC, the event-giving club, their members, directors, governors, officers, agents, superintendents or event secretary and the owner and/or lessor of the premises and any provider of services that are necessary to hold this event and any employees or volunteers of the aforementioned parties, and any AKC approved judge, judging at this event, harmless from any claim for loss or injury which may be alleged to have been caused directly or indirectly to any person or thing by the act of this dog while in or about the event premises or grounds or near any entrance thereto, and I (we) personally assume all responsibility and liability for any such claim; and I (we) further agree to hold the aforementioned parties harmless from any claim of loss, injury or damage to this dog.

Additionally, I (we) hereby assume the sole responsibility for and agree to indemnify, defend and save the aforementioned parties harmless from any and all loss and expense (including legal fees) by reason of the liability imposed by law upon any of the aforementioned parties for damage because of bodily injuries, including death at any time resulting therefrom, sustained by any person or persons, including myself (ourselves), or on account of damage to property, arising out of or in consequence of my (our) participation in this event, however such, injuries death or property damage may be caused, and whether or not the same may have been caused or may be alleged to have been caused by the negligence of the aforementioned parties or any of their employees, agents, or any other person. I (we) agree that the determination of whether the injury is serious shall be made by the event veterinarian and is binding on me (us). I (WE) AGREE THAT ANY CAUSE OF ACTION, CONTROVERSY OR CLAIM ARISING OUT OF OR RELATED TO THE ENTRY, EXHIBITION OR ATTENDANCE AT THE EVENT BETWEEN THE AKC AND THE EVENT-GIVING CLUB (UNLESS OTHERWISE STATED IN THIS PREMIUM LIST) AND MYSELF (OURSELVES) OR AS TO THE CONSTRUCTION, INTERPRETATION AND EFFECT OF THIS AGREEMENT SHALL BE SETTLED BY ARBITRATION PURSUANT TO THE APPLICABLE RULES OF THE AMERICAN ARBITRATION ASSOCIATION. HOWEVER, PRIOR TO ARBITRATION ALL APPLICABLE AKC BYLAWS, RULES, REGULATIONS, AND PROCEDURES MUST FIRST BE FOLLOWED AS SET FORTH IN THE AKC CHARTER AND BYLAWS, RULES, REGULATIONS, PUBLISHED POLICIES AND GUIDELINES.

**SIGNATURE** of owner or his agent duly authorized to make this entry.

**SIGN HERE**

**X:** \_\_\_\_\_

**Phone #:** \_\_\_\_\_

**Email:** \_\_\_\_\_

**In case of Emergency – Name:** \_\_\_\_\_ **Phone #:** \_\_\_\_\_